



PINPOINT SECURITY MAGNETICALLY CONTACT DETECTOR IO 102-39



Description

Detector IO 102-39 designed to lock the metal door and window openings, safes, organizing devices like "trap, and blocking of other constructive elements of buildings and structures for the opening or offset with the issuance of the alarm signal by switching contacts of reed switch on the control panel.

Recommend to install detectors in metal construction with metal thickness of 0.5 mm or more.

Dimensions

Dimensions in mm

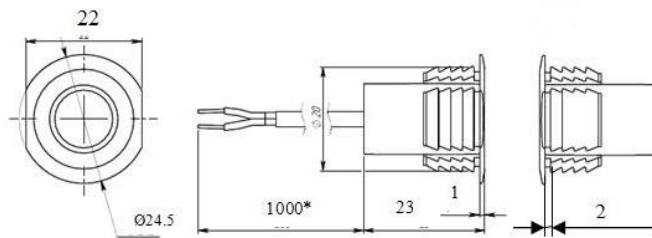

Electrical characteristics

Switching current	≤0,25A
Switching voltage	≤72V
Switching power max	10W,VA
Operating temperature	-50...+50°C
Humidity	90%
Contact resistance	0,5 Ω
Sensor/magnet weight, g, max	30,0/14,0

Time to failure of the detector not less than 20 000 hours.

The detector is a non-renewable product.

Execution type	Reed switch type	length of the output, mm
-00	normally open contact	1500 (double insulation), Ø3mm
-01	changeover contact	1500 (double insulation), Ø3,5mm

Detector	Sensing distance (not metal construction),mm	Sensing distance (metal construction), mm	Max allowed coaxility the location of the reed switch and magnet, mm
IO 102-39-00	35	22	±5
IO 102-39-01	18	13	±5