



«MAGNITO-KONTAKT» Ltd

51B, place H4, Novaya St., 390027 Ryazan, Russia, phone +7 915 622-20-57
E-mail: olya374@rambler.ru; 451694@bk.ru <http://www.m-kontakt.ru>

PINPOINT SECURITY MAGNETICALLY CONTACT DETECTOR IO 102-6 IO 102-6S (switch contact)



Description

Detectors are designed to lock the metal door and window openings, safes, organization of devices of type "trap", and blocking of other constructive elements of buildings and structures for the opening or offset with the issuance of the alarm signal by breaking (opening or closing to IO 102-6S) the reed switch contacts on the control device.

Dimensions

Dimensions in mm

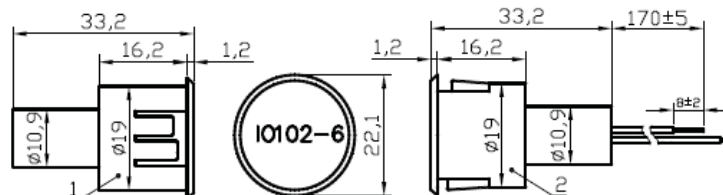

Electrical characteristics

Switching current	≤0,3A
Switching voltage	≤72V
Switching power max	10W,VA
Operating temperature	-50...+50°C
Humidity	98%
Contact resistance	0,5 Ω
Sensor/magnet weight, g, max	7,0/7,0

Time to failure of the detector not less than 20 000 hours.

The detector is a non-renewable product.

Detector	Sensing distance (not metal construction),mm	Sensing distance (metal construction), mm	Max allowed coaxility the location of the reed switch and magnet, mm
IO 102-6	10	7	±3
IO 102-6S	7	5	±3