



REED MAGNETIC POSITION SENSOR KM-250 “ARTOL” type100



Description

Sensor KM-250 “ARTOL” type100 is designed for switching AC circuits in control systems, locks, structural elements of buildings and structures for the opening or displacement with generation of a signal by switching of AC circuits.

Sensor is designed for switching AC circuits with voltage up to 250 V.

ATTENTION: Sensor KM-250 “ARTOL” type100 is designed to work only in AC circuits of 50/60 Hz!

Dimensions

Dimensions in mm

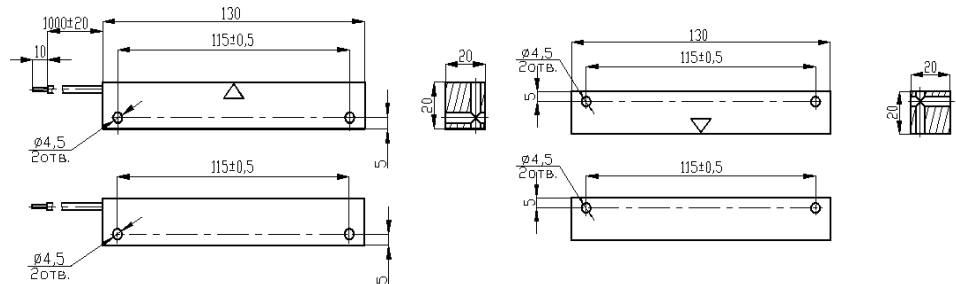

Enclosure of the position sensor KM-250 “ARTOL” type100 is made metal.

Electrical characteristics

Switching current	≤3,0A
Switching voltage	≤250V AC 50/60 Hz
Switching power max	500W,VA (active, inductive load)
Dimensions	Sensor - 130*20*20mm Magnet - 130*20*20mm
Weight	Sensor - 0,1kg Magnet - 0,15kg
Operating temperature	-50...+85°C
Humidity	100%

Sensor Magnet	KM-250-NO “ARTOL”200 normally open contact	KM-250-NC “ARTOL”200 normally close contact	KM-250-NO-NC “ARTOL”200 changeover contact
	Contacts of the sensor on non-magnetic surfaces: close ≤65mm open ≥73mm	Contacts of the sensor on non-magnetic surfaces: open ≤60mm close ≥90mm	Contacts of the sensor on non-magnetic surfaces: switch ≤60mm switch back ≥90mm
	Contacts of the sensor on magnetic surfaces: close ≤55mm open ≥65mm	Contacts of the sensor on magnetic surfaces: open ≤55mm close ≥70mm	Contacts of the sensor on magnetic surfaces: switch ≤55mm switch back ≥70mm